

## venue specification – G1 gallery

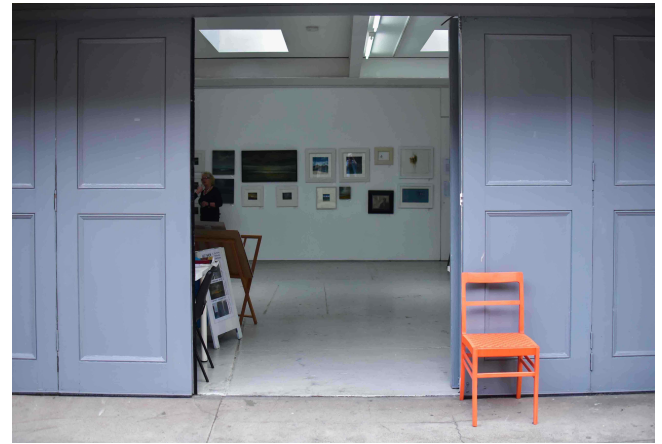
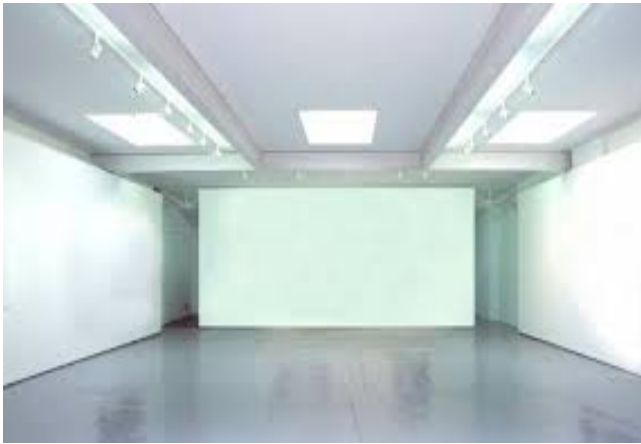

Our G1 gallery is a unique creative space ideal for exhibitions, events, workshops, small seminars and talks. Part of Gayfield Creative Spaces, located in central Edinburgh, it is close to the tram, rail and bus termini. G1 gallery has a separate street level entrance, toilet and a small kitchen area. It can be hired individually or in combination with our other creative spaces.

### Specification

Floor space:	75m <sup>2</sup>
Dimensions:	width – 7.95 wide depth – 9.6m height – 2.9m
Capacity:	60 theatre style, 120 reception
Facilities:	high speed Wi-Fi internet connection toilet (4.5m <sup>2</sup> ) kitchen area 3 roof skylights provide natural light (easily blacked out), strip lights roof beams for additional lighting (access ladder available)
Additional information:	full-length concertina doors allow open access to gallery black theatre curtain available to cover concertina doors variety of exhibition furniture and equipment available for events there is a ramp access to our G2 kiosk space we offer additional support and marketing for event organisers

Section



Plan

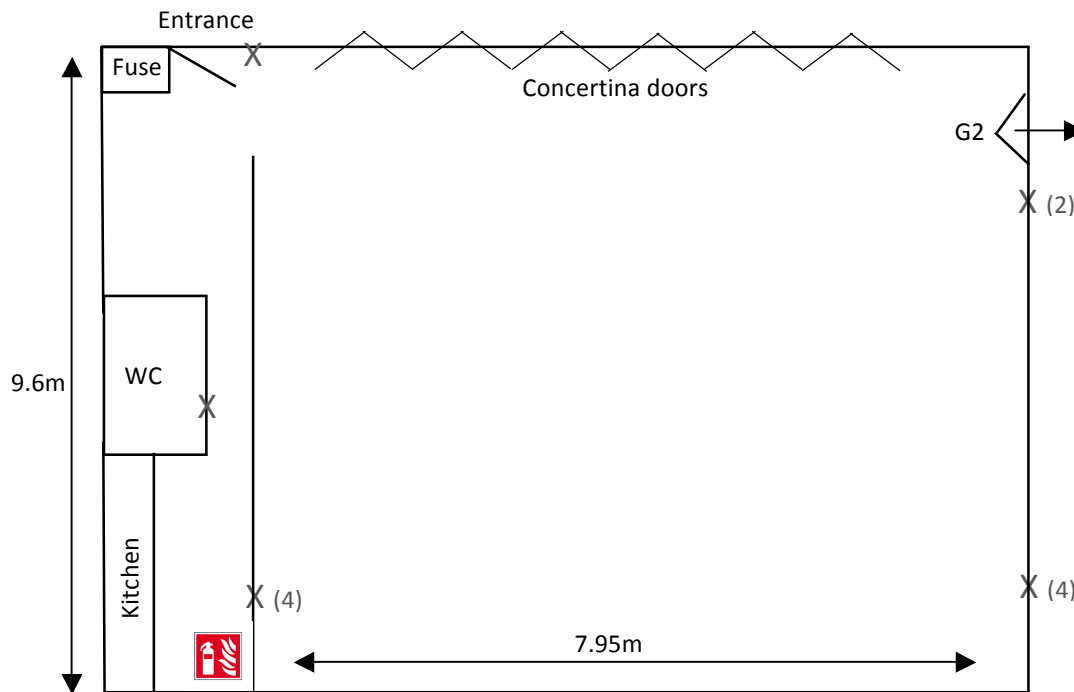

X – sockets (no.)

Please Note: All dimensions are approximate and should be confirmed in the venue prior to your event. Please have a look at our events archive for examples of this venue in use.

G1Spec (Feb2016)

gayfield creative spaces / 11 gayfield square / Edinburgh / eh1 3nt a hub for collaboration in central Edinburgh

contact us: [info@gayfield.co.uk](mailto:info@gayfield.co.uk)

follow us on twitter: [@gayfieldsq](https://twitter.com/gayfieldsq)

like us on facebook: [@gayfieldsq](https://www.facebook.com/gayfieldsq)